

Standard Wall-Mounted Cabinet

Part Number: LPRWXXXXXXXX



Front



Rear

Product Description

The wall-mounted cabinets are ideal for maximizing vertical space specialized design to house and organize networking equipment, such as routers, switches, patch panels, servers, and other IT hardware. These cabinets are commonly used in data centers, server rooms, offices, and even small businesses to ensure proper cable management, ventilation, and security for critical networking components.

Feature & Benefit

■ 19-Inch Wall Mounted structure design

Hight: Available for 6U,9U,12U,15U and 18U

Width: 600mm

Depth: 600mm

■ Maximum loading capacity

Static load: Max.150KG

■ Intelligent Cooling System

Active cooling system on top of the rack (option)

■ Security for device Lockable Doors and Panels

Lockable Doors and side Panels

Mechanical lock for front door

■ Package for deliver

Pre-assembled package

■ Compatibility with Industry Standards

ANSI/EIA RS-310-E

IEC60297-3-100

DIN41491:PART1

DIN41494:PART7

GB/T 19520.16-2015

Product outline

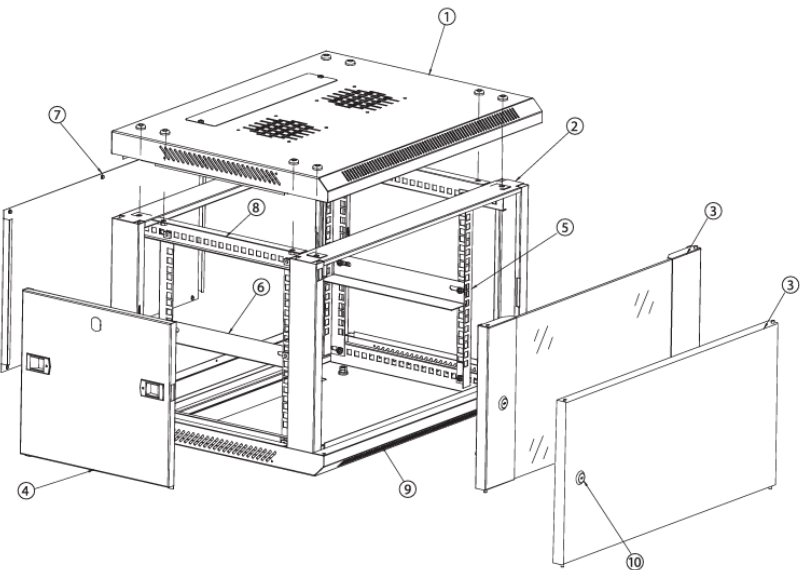
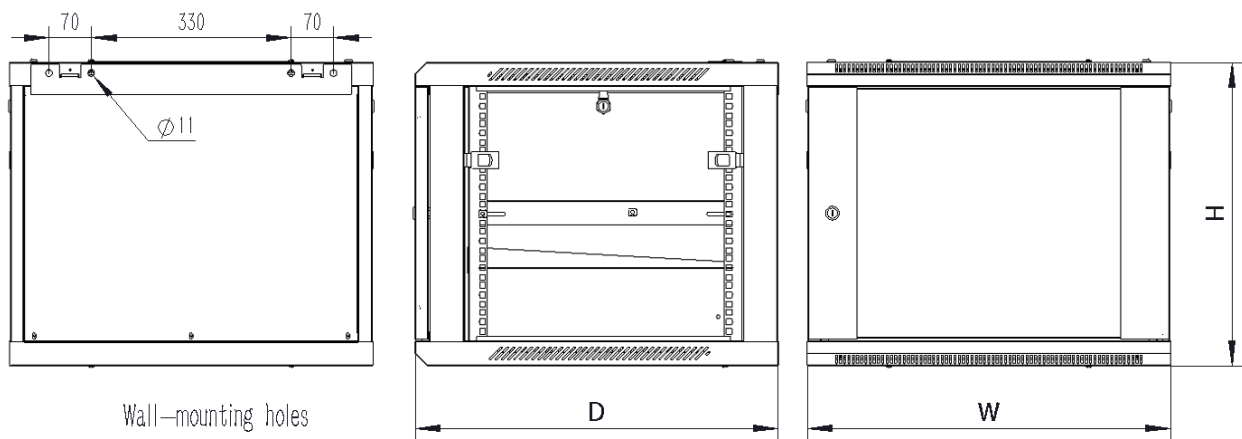

Item	Part	Qty
1	Top cover	1
2	Frame	2
3	Front door	1
4	Side panel	2
5	Upright Rail	4
6	L-shaped bracket	2
7	Back plate	1
8	Beam	4
9	Bottom panel	1
10	Door Lock	1

Specifications

Model	Height(H)	Width(W)	Depth(D)	Net Weight	Static Load
6HU	370mm	600mm	600mm	10kg	60kg
9HU	500mm	600mm	600mm	15kg	80kg
12HU	635mm	600mm	600mm	20kg	100kg
15HU	770mm	600mm	600mm	25kg	120kg
18HU	900mm	600mm	600mm	30kg	150kg

Environmental Temperature

Item	Value
Operation temperature range	-10°C to +60°C
Storage temperature range	-20°C to +60°C
IP Rate	IP30
RoHS 2011/65/EU	compliant

Ordering information

LPRW XX 3 X 0 – 1 XX X – 0 X X

1 2 3 4 5 6 7 8 9 10

1

Height
06: 6U
09: 9U
12: 12U
15: 15U
18: 18U

2

Width and Depth
3: 600x600, mm

3

Front Door (single)
1: Plexiglass door
2: Tempered glass door
3: Mesh door

4

Rear Door
0: null

5

Material
1: SPCC

6

Color
BK: Black (RAL9005)
WH: White (RAL7032)

7

Package
2: Pre-assembled

8

Lock type
0: Standard lock

9

Fan type (Option)
0: Null
1: 2 Fan(190CFM/PCS、120mm x 120mm)
3: 2 Fan with temperature control

10

PDU type (Option)
0: Null
1: PDU IEC320 C19,16A, 6 ports
2: PDU IEC320 C13,16A, 8 ports

NOTES:

When the last three codes(xxx) is defined as 000, these three codes need to ignore.

Draft	Check	Approve	Date	Rev.	ECN	Name	Date
				01			